

5. REPORT

Background

5.1 An application for a new Premises Licence, by Mehmet Ickan and Rakkas Ltd in respect of 369 Green Lanes under the Licensing Act 2003.

5.2 Details of the application being sought under the Premises Licence-APP 1

Regulated Entertainment: Live Music

Monday to Saturday 1800 to 2300 hours

Supply of Alcohol

Sunday to Thursday 1100 to 2300 hours

Friday & Saturday 1100 to 0200 hours

For consumption ON the premises

Hours open to the public

Sunday to Thursday 0600 to 2330 hours

Friday & Saturday 0600 to 0230 hours

General-all four licensing objectives

As below;

Also all Health and Safety steps will be taken and training will be given to staff including food and hygiene.

5.3 Crime and Disorder

CCTV

Security men

5.4 Public Safety

CCTV

Emergency Exit signs

Fire alarm

Smoke detector

Safety lights

5.5 Public Nuisance

CCTV

Security men

Sound proofing

5.6 Child Protection

Designated area at front away from smoke area at back.

6. RELEVANT REPRESENTATIONS (CONSULTATION)

Responsible authorities:

6.1 Comments of Metropolitan Police

Have made representation. **APP 2**

6.2 Comments of Regulatory Services:

Environmental Health

Have made representation regarding this application. **APP 3**

Trading Standards

Have made no representation to this application

6.3 London Fire and Civil Defence Authority

Have made no representation to this application

6.4 Planning Services

Comments made regarding this application. **APP 4**

6.5 Comments of Child Protection Agency or Nominee

No representation made on this matter

7.0 Interested Parties

No letters of representation has been received against this application.

8.0 Financial Comments

The fee which would be applicable for this application was **£190.00**.

The Panel is asked to note that the operating schedule does not give any wording as to the conditions proposed by the applicant. Members are asked to ensure that enforceable conditions are imposed from the wording offered by the applicant.

APPENDIX 1-- APPLICATION

£140.
K51028021
26/01/12

Application for a premises licence to be granted under the Licensing Act 2003

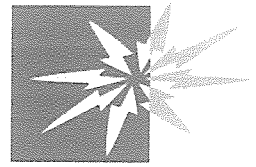

Haringey Council

(1)

Reference number:

PLEASE READ THE FOLLOWING INSTRUCTIONS FIRST

Before completing this form please read the guidance notes at the end of the form. If you are completing this form by hand please write legibly in block capitals. In all cases ensure that your answers are inside the boxes and written in black ink. Use additional sheets if necessary. You may wish to keep a copy of the completed form for your records

(2) I/We

apply for a premises licence under section 17 the Licensing Act 2003 for the premises described in Part 1 below (the premises) and I/we are making this application to you as the relevant licensing authority in accordance with section 12 of the Licensing Act 2003

Part 1 - Premises details

Postal address of premises or, if none, Ordnance Survey map reference or description	
369 GREEN LANES HARINGEY	
Post town	LONDON
Postcode	N4 1DY

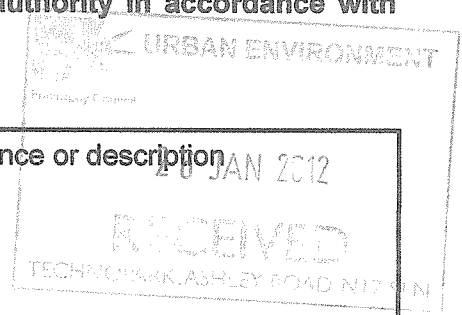

Telephone number at premises(if any)	0203 4892515
Non-domestic rateable value of premises	£ 6,700

Part 2 - Applicant details

Please state whether you are applying for a premises licence as

- Please tick yes
- a) an individual or individuals* please complete section (A)
 - b) a person other than an individual*
 - i. as a limited company please complete section (B)
 - ii. as a partnership please complete section (B)
 - iii. as an unincorporated association; or please complete section (B)
 - iv. other (for example a statutory corporation) please complete section (B)

(1) Insert name and address of relevant licensing authority and its reference number (optional)
(2) Insert name(s) of applicant

- c) a recognised club please complete section (B)
- d) a charity please complete section (B)
- e) the proprietor of an educational establishment please complete section (B)
- f) a health service body please complete section (B)
- g) a person who is registered under Part 2 of the Care Standards Act 2000 (c14) in respect of an independent hospital please complete section (B)
- h) the chief officer of police of a police force in England and Wales please complete section (B)

* If you are applying as a person described in (a) or (b) please confirm:

- Please tick yes
- I am carrying on or proposing to carry on a business which involves the use of the premises for licensable activities; or
 - I am making the application pursuant to
 - a statutory function; or
 - a function discharged by virtue of Her Majesty's prerogative

(A) INDIVIDUAL APPLICANTS (fill in as applicable)

Mr Mrs Miss Ms Other title (for example, Rev)

Surname First names

I am 18 years old or over Please tick yes

Date of birth

Day	Month	Year
1	4	02 19 65

Current postal address if different from premises address

~~XXXXXXXXXX ROAD~~ ~~XXXXXX~~ ~~XXXXXX~~ 369 GREEN LANES
LONDON
N4 1DY

Post town Postcode

Daytime contact telephone number

E-mail address (optional)

SECOND INDIVIDUAL APPLICANT (if applicable)

Mr

Mrs

Miss

Ms

Other title
(for example, Rev)

Surname

First names

I am 18 years old or over Please tick yes

Date of birth

Day	Month	Year
<input type="text"/>	<input type="text"/>	<input type="text"/>

Current postal address if different from premises address

Post town	Postcode
-----------	----------

Daytime contact telephone number

E-mail address (optional)

(B) OTHER APPLICANTS

Please provide name and registered address of applicant in full. Where appropriate please give any registered number. In the case of a partnership or other joint venture (other than a body corporate), please give the name and address of each party concerned.

Name	RAKKAS LTD
Address	369 GREEN LANES HARINGEY LONDON N4 1DY
Registered number (where applicable)	7856459
Description of applicant (for example partnership, company, unincorporated association etc.)	DIRECTOR - MEHMET ICKAN
Telephone number (if any)	0203 4892515
E-mail address (optional)	

Part 3 - Operating Schedule

When do you want the premises licences to start?

Day		Month		Year			
0	1	0	2	2	0	1	2

If you wish the licence to be valid only for a limited period, when do you want it to end?

Day		Month		Year			

Please give a general description of the premises (please read guidance note 1)

GENERAL LICENSED RESTAURANT
GARDEN
WITH OUTDOOR SPACE FOR SHISHA

If 5,000 or more people are expected to attend the premises at any one time, please state the number expected to attend

--

What licensable activities do you intend to carry on from the premises?
(Please see sections 1 and 14 of the Licensing Act 2003 and Schedule 1 and 2 to the Licensing Act 2003)

Provision of regulated entertainment

Please tick yes

- a) plays (if ticking yes, fill in box A)
- b) films (if ticking yes, fill in box B)
- c) indoor sporting events (if ticking yes, fill in box C)
- d) boxing or wrestling entertainment (if ticking yes, fill in box D)
- e) live music (if ticking yes, fill in box E)
- f) recorded music (if ticking yes, fill in box F)
- g) performances of dance (if ticking yes, fill in box G)
- h) anything of a similar description to that falling within (e), (f) or (g)
(if ticking yes, fill in box H)

Provision of entertainment facilities for:

- i) making music (if ticking yes, fill in box I)
- j) dancing (if ticking yes, fill in box J)
- k) entertainment of a similar description to that falling within (i) or (j)
(if ticking yes, fill in box K)

Provision of late night refreshment (if ticking yes, fill in box L)

Supply of alcohol (if ticking yes, fill in box M)

In all cases complete boxes N, O and P

A

Plays			Will the performance of a play take place indoors or outdoors or both - please tick <input checked="" type="checkbox"/> (please read guidance note 2) Indoors <input type="checkbox"/> Outdoors <input type="checkbox"/> Both <input type="checkbox"/>
Day	Start	Finish	
Mon			Please give further details here (please read guidance note 3)
Tue			State any seasonal variations for performing plays (please read guidance note 4)
Wed			Non-standard timings. Where you intend to use the premises for the performance of plays at different times from those listed in the column on the left, please list (please read guidance note 5)
Thur			
Fri			
Sat			
Sun			

B

Films			Will the exhibition of films take place indoors or outdoors or both - please tick <input checked="" type="checkbox"/> (please read guidance note 2) Indoors <input type="checkbox"/> Outdoors <input type="checkbox"/> Both <input type="checkbox"/>
Day	Start	Finish	
Mon			Please give further details here (please read guidance note 3)
Tue			State any seasonal variations for the exhibition of films (please read guidance note 4)
Wed			Non-standard timings. Where you intend to use the premises for the exhibition of films at different times from those listed in the column on the left, please list (please read guidance note 5)
Thur			
Fri			
Sat			
Sun			

C

Indoor sporting events Standard days and timings (please read guidance note 6)			Please give further details here (please read guidance note 3)
Day	Start	Finish	
Mon			
Tue			State any seasonal variations for indoor sporting events (please read guidance note 4)
Wed			Non-standard timings. Where you intend to use the premises for indoor sporting events at different times from those listed in the column on the left, please list (please read guidance note 5)
Thur			
Fri			
Sat			
Sun			

D

Boxing or wrestling entertainments Standard days and timings (please read guidance note 6)			Will the boxing or wrestling entertainment take place indoors or outdoors or both - please tick <input checked="" type="checkbox"/> (please read guidance note 2)		
Day	Start	Finish	Indoors <input type="checkbox"/> Outdoors <input type="checkbox"/> Both <input type="checkbox"/>		
Mon			Please give further details here (please read guidance note 3)		
Tue			State any seasonal variations for boxing or wrestling entertainment (please read guidance note 4)		
Wed			Non-standard timings. Where you intend to use the premises for boxing or wrestling entertainment at different times from those listed in the column on the left, please list (please read guidance note 5)		
Thur					
Fri					
Sat					
Sun					

E

Live music			Will the performance of live music take place indoors or outdoors or both - please tick <input checked="" type="checkbox"/> (please read guidance note 2) Indoors <input checked="" type="checkbox"/> Outdoors <input type="checkbox"/> Both <input type="checkbox"/>
Standard days and timings (please read guidance note 6)			
Day	Start	Finish	Please give further details here (please read guidance note 3)
Mon	12.00	23.00	
Tue	12.00	23.00	
Wed	12.00	23.00	State any seasonal variations for the performance of live music (please read guidance note 4)
Thur	12.00	23.00	
Fri	12.00	23.00	Non-standard timings. Where you intend to use the premises for the performance of live music at different times from those listed in the column on the left, please list (please read guidance note 5)
Sat	12.00	23.00	
Sun	-	-	

F

Recorded music			Will the playing of recorded music take place indoors or outdoors or both - please tick <input checked="" type="checkbox"/> (please read guidance note 2) Indoors <input checked="" type="checkbox"/> Outdoors <input type="checkbox"/> Both <input type="checkbox"/>
Standard days and timings (please read guidance note 6)			
Day	Start	Finish	Please give further details here (please read guidance note 3)
Mon	00.00	23.00	
Tue	00.00	23.00	
Wed	00.00	23.00	State any seasonal variations for the playing of recorded music (please read guidance note 4)
Thur	00.00	23.00	
Fri	00.00	02.00	Non-standard timings. Where you intend to use the premises for the playing of recorded music entertainment at different times from those listed in the column on the left, please list (please read guidance note 5)
Sat	00.00	02.00	
Sun	10.00	23.00	

G

Performances of dance Standard days and timings (please read guidance note 6)			Will the performance of dance take place indoors or outdoors or both - please tick <input checked="" type="checkbox"/> (please read guidance note 2) Indoors <input type="checkbox"/> Outdoors <input type="checkbox"/> Both <input type="checkbox"/>
Day	Start	Finish	
Mon			Please give further details here (please read guidance note 3)
Tue			
Wed			State any seasonal variations for the performance of dance (please read guidance note 4)
Thur			
Fri			Non-standard timings. Where you intend to use the premises for the performance of dance entertainment at different times from those listed in the column on the left, please list (please read guidance note 5)
Sat			
Sun			

H

Anything of a similar description to that falling within (e), (f) or (g) Standard days and timings (please read guidance note 6)			Please give a description of the type of entertainment you will be providing
Day	Start	Finish	
Mon			Will this entertainment take place indoors or outdoors or both - please tick <input checked="" type="checkbox"/> (please read guidance note 2) Indoors <input type="checkbox"/> Outdoors <input type="checkbox"/> Both <input type="checkbox"/>
Tue			Please give further details here (please read guidance note 3)
Wed			
Thur			State any seasonal variations for entertainment of a similar description to that falling within (e), (f) or (g) (please read guidance note 4)
Fri			
Sat			Non-standard timings. Where you intend to use the premises for the entertainment of similar description to that falling within (e), (f) or (g) at different times from those listed in the column on the left, please list (please read guidance note 5)
Sun			

Provision of facilities for making music			Please give a description of the facilities for making music you will be providing	
Standard days and timings (please read guidance note 6)			Will the facilities for making music be indoors or outdoors or both - please tick <input checked="" type="checkbox"/> (please read guidance note 2) Indoors <input type="checkbox"/> Outdoors <input type="checkbox"/> Both <input type="checkbox"/>	
Day	Start	Finish	Please give further details here (please read guidance note 3)	
Mon				
Tue				
Wed				State any seasonal variations for the provision of facilities for making music (please read guidance note 4)
Thur				
Fri				Non-standard timings. Where you intend to use the premises for provision of facilities for making music at different times from those listed in the column on the left, please list (please read guidance note 5)
Sat				
Sun				

J

Provision of facilities for dancing			Please give a description of the facilities for dancing you will be providing	
Standard days and timings (please read guidance note 6)			Will the facilities for dancing be indoors or outdoors or both - please tick <input checked="" type="checkbox"/> (please read guidance note 2) Indoors <input type="checkbox"/> Outdoors <input type="checkbox"/> Both <input type="checkbox"/>	
Day	Start	Finish	Please give further details here (please read guidance note 3)	
Mon				
Tue				
Wed				State any seasonal variations for providing dancing facilities (please read guidance note 4)
Thur				
Fri				Non-standard timings. Where you intend to use the premises for the provision of facilities for dancing entertainment at different times from those listed in the column of the left, please list (please read guidance note 5)
Sat				
Sun				

K

Provision of facilities for entertainment of a similar description to that falling within I or J			Please give a description of the type of entertainment facility you will be providing
Standard days and timings (please read guidance note 6)			Will the entertainment facility be indoors or outdoors or both - please tick <input checked="" type="checkbox"/> (please read guidance note 2)
Day	Start	Finish	Indoors <input type="checkbox"/> Outdoors <input type="checkbox"/> Both <input type="checkbox"/>
Mon			Please give further details here (please read guidance note 3)
Tue			
Wed			State any seasonal variations for the provision of facilities for entertainment of a similar description to that falling within I or J (please read guidance note 4)
Thur			
Fri			Non-standard timings. Where you intend to use the premises for the provision of facilities for entertainment of a similar description to that falling within I or J at different times from those listed in the column on the left, please list (please read guidance note 5)
Sat			
Sun			

L

Late night refreshment Standard days and timings (please read guidance note 6)			Will the provision of late night refreshment take place indoors or outdoors or both - please tick <input checked="" type="checkbox"/> (please read guidance note 2)
			Indoors <input checked="" type="checkbox"/> Outdoors <input type="checkbox"/> Both <input type="checkbox"/>
Day	Start	Finish	Please give further details here (please read guidance note 3)
Mon	06.00	23.00	
Tue	06.00	23.00	
Wed	06.00	23.00	State any seasonal variations for the provision of late night refreshment (please read guidance note 4)
Thur	06.00	23.00	
Fri	06.00	23.00	Non-standard timings. Where you intend to use the premises for the provision of late night refreshment at different times from those listed in the column on the left, please list (please read guidance note 5)
Sat	06.00	23.00	
Sun	06.00	23.00	

M

Supply of alcohol Standard days and timings (please read guidance note 6)			Will the sale of alcohol be for consumption - please tick box <input checked="" type="checkbox"/> (please read guidance note 7)
			On the premises <input checked="" type="checkbox"/> Off the premises <input type="checkbox"/> Both <input type="checkbox"/>
Day	Start	Finish	State any seasonal variations for the supply of alcohol (please read guidance note 4)
Mon	11.00 am	23.00	
Tue	11.00	23.00	
Wed	11.00	23.00	Non-standard timings. Where you intend to use the premises for the supply of alcohol at different times from those listed in the column on the left, please list (please read guidance note 5)
Thur	11.00	23.00	
Fri	11.00	02.00	
Sat	11.00	02.00	
Sun	11.00	23.00	

State the name and details of the individual whom you wish to specify on the licence as premises supervisor

Name **MEHMET ICKAN**
 Address **13 LEIGH COURT CLEWLANDS ROAD**
 Postcode **E18 2AG.**
 Personal Licence number (if known)
 Issuing licensing authority (if known)

N

Please highlight any adult entertainment or services, activities, other entertainment or matters ancillary to the use of the premises that may give rise to concern in respect of children (please read guidance note 8)

THERE IS BACK GARDEN OUTDOOR SPACE WHICH WILL BE USED FOR SHISHA.

O

Hours premises are open to the public
 Standard days and timings
 (please read guidance note 6)

Day	Start	Finish
Mon	06.00	23.30
Tue	06.00	23.30
Wed	06.00	23.30
Thur	06.00	23.30
Fri	06.00	02.30
Sat	06.00	02.30
Sun	06.00	23.30

State any seasonal variations (please read guidance note 4)

PLEASE NOTE THAT GARDEN SECTION
 OPEN FROM
 WILL ~~CLOSE~~ 07.00 AM TO 21.00
 MON TO THURS & SUN
 07.00 AM - 23.30
~~FRI~~ FRI - SAT.

Non-standard timings. Where you intend to use the premises to be open to the public at different times from those listed in the column on the left, please list (please read guidance note 5)

P Describe the steps you intend to take to promote the four licensing objectives:

a) General - all four licensing objectives (b, c, d, e) (please read guidance note 9)

AS BELOW
ALSO ALL HEALTH & SAFETY STEPS WILL BE TAKEN &
TRAINING WILL BE GIVEN TO STAFF.
INCLUDING FOOD & HYGIENE

b) The prevention of crime and disorder

CCTV
SECURITY MEN

c) Public safety

CCTV
EMERGENCY EXITS SIGNS
FIRE ALARM
SMOKE DETECTOR.
SAFETY LIGHTS

d) The prevention of public nuisance

CCTV,
SECURITY MEN
SOUND PROOFING

e) The protection of children from harm

DESIGNATED AREA AT FRONT AWAY FROM SMOKE AREA AT BACK

CHECKLIST:

Please tick ✓

- I have made or enclosed payment of the fee
- I have enclosed the plan of the premises
- I have sent copies of this application and the plan to responsible authorities and others where applicable
- I have enclosed the consent form completed by the individual I wish to be premises supervisor, if applicable
- I understand that I must now advertise my application
- I understand that if I do not comply with the above requirements my application will be rejected

IT IS AN OFFENCE, LIABLE ON CONVICTION TO A FINE UP TO LEVEL 5 ON THE STANDARD SCALE, UNDER SECTION 158 OF THE LICENSING ACT 2003 TO MAKE A FALSE STATEMENT IN OR IN CONNECTION WITH THIS APPLICATION

Part 4 - Signatures (please read guidance note 10)

Signature of applicant or applicant's solicitor or other duly authorised agent. (Please read guidance note 11)
If signing on behalf of the applicant please state in what capacity.

Signature 

Date 23.01.2012

Capacity DIRECTOR

For joint applications signature of 2nd applicant, 2nd applicant's solicitor or other authorised agent.
(Please read guidance note 12)

If signing on behalf of the applicant please state in what capacity.

Signature _____

Date

Capacity

Contact name (where not previously given) and postal address for correspondence associated with this application (please read guidance note 13)

DEE CIFTCI - D CONNECTIONS
649 HIGH ROAD
TOTTENHAM
LONDON

Post town N17 8AA

Postcode N17 8AA

Telephone number (if any) 07939466335

If you would prefer us to correspond with you by e-mail your e-mail address (optional)

dilek.ciftci@hotmail.co.uk

Notes for Guidance

1. Describe the premises. For example the type of premises, its general situation and layout and any other information which could be relevant to the licensing objectives. Where your application includes off-supplies of alcohol and you intend to provide a place for consumption of these off-supplies you must include a description of where the place will be and its proximity to the premises.
 2. Where taking place in a building or other structure please tick as appropriate. Indoors may include a tent.
 3. For example the type of activity to be authorised, if not already stated, and give relevant further details, for example (but not exclusively) whether or not music will be amplified or unamplified.
 4. For example (but not exclusively), where the activity will occur on additional days during the summer months.
 5. For example (but not exclusively), where you wish the activity to go on longer on a particular day e.g. Christmas Eve.
 6. Please give timings in 24 hour clock (e.g. 16:00) and only give details for the days of the week when you intend the premises to be used for the activity.
 7. If you wish people to be able to consume alcohol on the premises please tick 'on the premises', if you wish people to be able to purchase alcohol to consume away from the premises please tick 'off the premises'. If you wish people to be able to do both please tick 'both'.
 8. Please give information about anything intended to occur at the premises or ancillary to the use of the premises which may give rise to concern in respect of children, regardless of whether you intend children to have access to the premises, for example (but not exclusively) nudity or semi-nudity, films for restricted age groups, the presence of gaming machines.
 9. Please list here steps you will take to promote all four licensing objectives together.
 10. The application form must be signed.
 11. An applicant's agent (for example solicitor) may sign the form on their behalf provided that they have actual authority to do so.
 12. Where there is more than one applicant, both applicants or their respective agents must sign the application form.
 13. This is the address which we shall use to correspond with you about this application.
 14. The information you have provided will be held by the Council on computerised and manual files. The data may also be disclosed to other departments within the Council or other organisations, but only in order to ensure compliance with relevant legislation or to detect and prevent fraud or a crime.
-

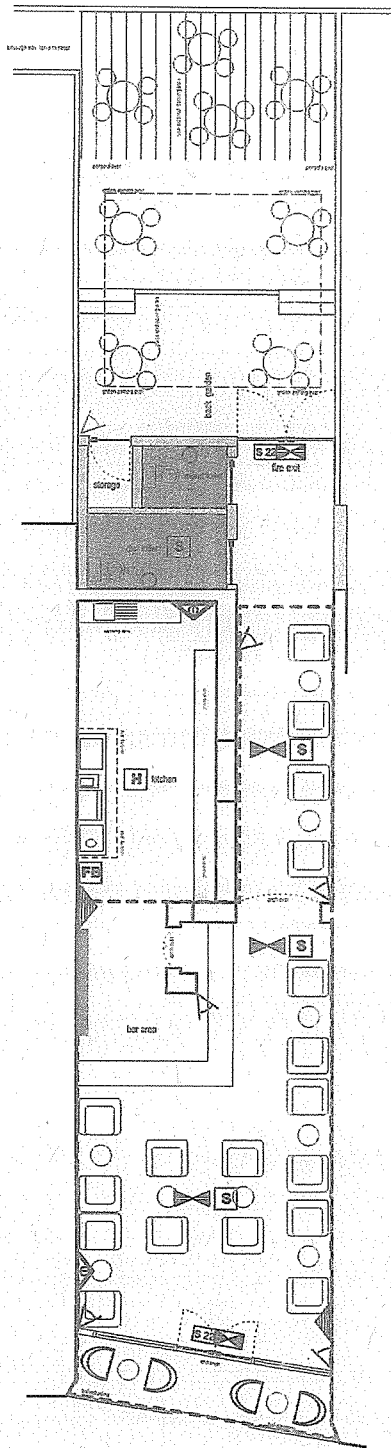

LEGEND

- WC AREA
- FRIDGES
- LIQUOR
- ALCOHOL AREA
- AMBIT OF LICENSED PREMISES
- SAFETY LIGHTS
- SMOKE DETECTOR
- CARBON DIOXIDE FIRE EXTINGUISHER
- 9 LT. WATER FIRE EXTINGUISHER
- FIRE DOOR
- FIRE ESCAPE KEEP CLEAR
- CCTV
- INTERNALLY ILLUMINATED FIRE ESCAPE SIGN (BS 5266)
- FIRE BLANKET
- BURGLAR ALARM
- FAN 6lt/s
- FIRE ALARM BELL
- BREAK GLASS MANUAL ALARM CALL-POINT
- HEAT DETECTOR

B 14.02.2012 FIRE EXIT SHOWN HO
 revisions A 31.10.2011 DRAWING FINALISED HO

drawing
GROUND FLOOR PLAN

project
LICENSING APPLICATION

address
**369 GREEN LANES
 LONDON N4 1ST**

client _____ north

job no. drawing revision scale 1:100@ A3
 no. no. no. date 31.10.11
128 01 B drawn by HO

planning architecture construction building control
OGEL architecture construction

www.ogel.co STUDIO 13 HOXTON WORKS
 info@ogel.co 123 HOXTON STREET
 HACKNEY LONDON N1 6SH
 M 977 1746 1742 T 0207 012 1687

ground floor plan
 scale 1:100

